



BRISBANE CANCER CONFERENCE

20
26

26 – 27 November 2026

Brisbane Convention
and Exhibition Centre

Prospectus & Invitation to Sponsor



BRISBANE CANCER CONFERENCE

26 – 27 November 2026
Brisbane Convention
and Exhibition Centre

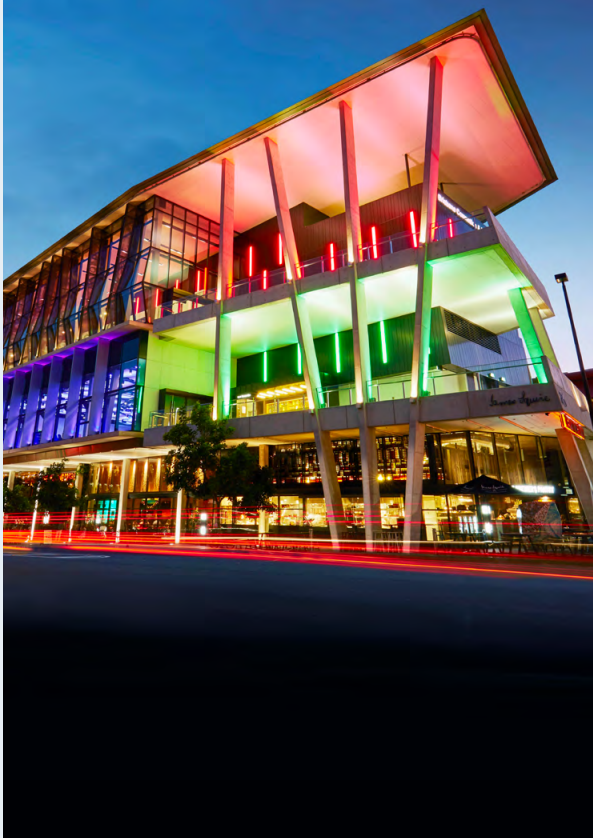

Dear Colleagues,

Welcome to the 13th Brisbane Cancer Conference. With the establishment of the Health Translation Queensland as an NHMRC Advanced Health research and translation Centre, this meeting is an opportunity to draw together cancer researchers in Brisbane and Queensland to advance collaborative efforts in cancer treatment and research.

The meeting comprises plenary lectures and workshops on recent scientific, technological, nursing, and medical advances in the diagnosis and treatment of malignant disease.

On Thursday 26th November, the meeting will start 8.00am with Breast, Lung and Prostate Cancer, Survivorship, and Immunotherapy symposia running from 8 – 11pm in the morning. The symposia will be followed by satellite symposia and plenary lectures. Subsequently there will be workshops from 4:30 – 6:30pm.

The symposium Gala dinner will be held on Thursday evening offering the opportunity to socialise with colleagues and patient advocates and consumers from other institutions, the city and Queensland.

The all-day session on Friday 27th November will include plenary lectures followed by tumour-site specific workshops in the morning and afternoon. A key session will be lectures by Queensland oncology researchers that have contributed to global advances in our understanding of the epidemiology, molecular biology, and treatment of malignant disease.

Over 1,000 delegates attended the event last year demonstrating the value of a truly multi-disciplinary annual Queensland Translational Cancer Conference in Brisbane.

This conference is made possible through the support of the PA Research Foundation, Health Translation Queensland, our sponsors, the time and effort of the chairs who put the workshops together and Therese and the QUT Cancer and Ageing Research Program (CARP) team.

Best wishes for what should be an enjoyable and fulfilling two days.

Yours sincerely,

Professor Ken O'Byrne

Your Host For BCC 2026



Professor Kenneth O'Byrne is a Medical Oncologist and Clinical Scientist working at the Princess Alexandra Hospital (PAH) and Queensland University of Technology (QUT) Translational Research Institute (TRI) laboratories on the PAH campus.

He is president of the British Thoracic Oncology Group (BTOG), a board member of the European thoracic oncology platform (ETOP), a member of the ESMO chest tumours faculty and is involved in the International Association for the Study of Lung Cancer (IASLC) and Thoracic Alliance for Cancer Trials (TACT). In Australia, he is a member of Australian Lung cancer Trials Group (ALTG), Medical Oncology Group of Australasia (MOGA) and Australian Genomics Health Alliance (AGHA).

Professor O'Byrne has been involved in over 250 Clinical Trials in his career including designing investigator initiated, grant-funded Phase II and III studies.

He has established collaborative studies and networks for biomarker detection and validation and has been involved in biomarker driven clinical trials including the LUX-Lung (Boehringer-Ingelheim), checkpoint immunotherapy (BMS, MSD) and the ETOP programs. He is clinical lead for the 'Cancer and Ageing Research Program' at PAH-QUT-TRI, his research including biomarker identification in solid and liquid biopsies, and drug resistance linked to cancer 'stemness' and genomic instability.

He has published over 450 peer-reviewed manuscripts and has patented novel anti-cancer therapeutics and predictive biomarker tests in Australia and Ireland. He and his collaborators have successfully applied for NHMRC, CCA, CCQ, Prostate Cancer Foundation of Australia (PCFA) and "Movember" grants in Australia.

Venue

Brisbane Convention & Exhibition Centre

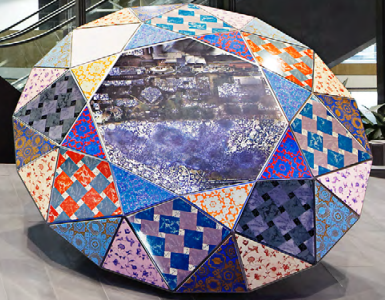

BRISBANE
CONVENTION
& EXHIBITION
CENTRE

Cnr Merivale and Glenelg Streets
South Bank, Brisbane
Queensland Australia

 www.bcec.com.au

The 2026 Brisbane Cancer Conference will be held at the Brisbane Convention and Entertainment Centre (BCEC), located in the iconic South Bank precinct.

The Centre is Earth Check Gold accredited and has been awarded AIPC Quality Standards Gold Certification for accomplishments in international convention centre performance standards. The Centre was the successful host venue for the 'best' 2014 G20 Leaders' Summit.

With the support of the Team from BCEC and support and sponsorship from our partners in Research, Education, and Industry we look forward to building on our success over previous Brisbane Cancer Conferences.

Registration

To register for the meeting please visit the [Brisbane Cancer Conference website](http://www.brisbanecancerconference.com.au).

Registration is free for non-industry attendees and for those industry delegates as described in the prospectus. **For industry attendees who are not sponsoring, a registration fee of \$500 per day will apply for attendance at the meeting.**

Venue Floor Plans

Plaza Level

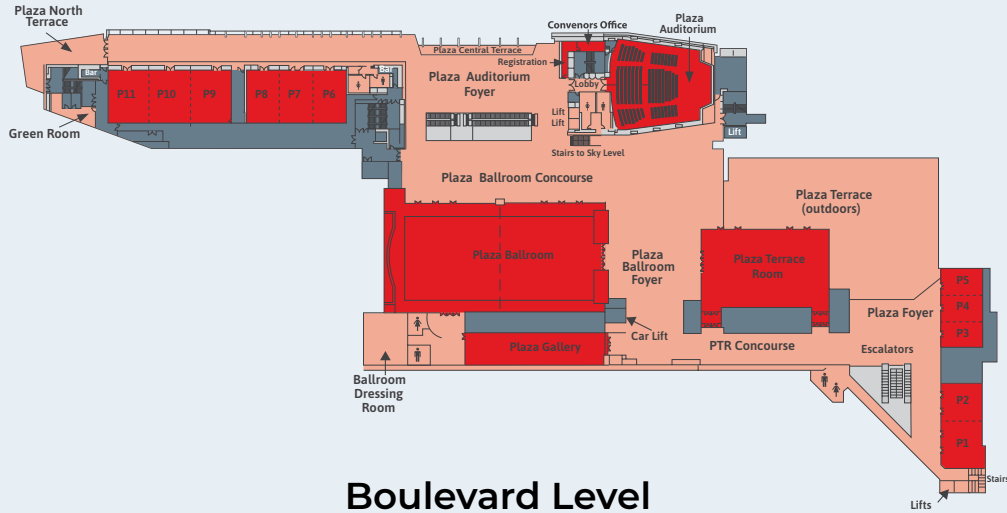

Boulevard Level

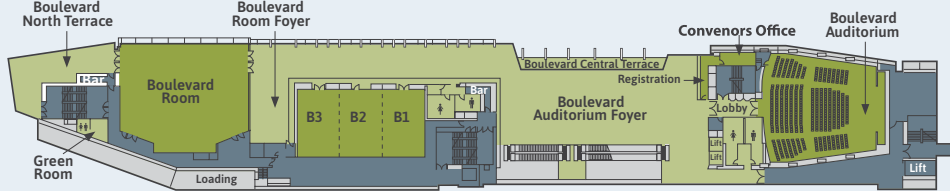

Sky Level

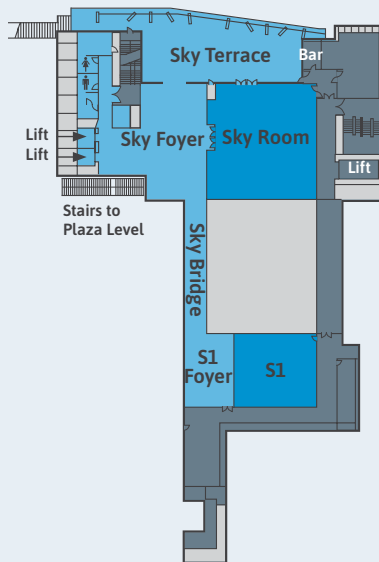

Concord Level

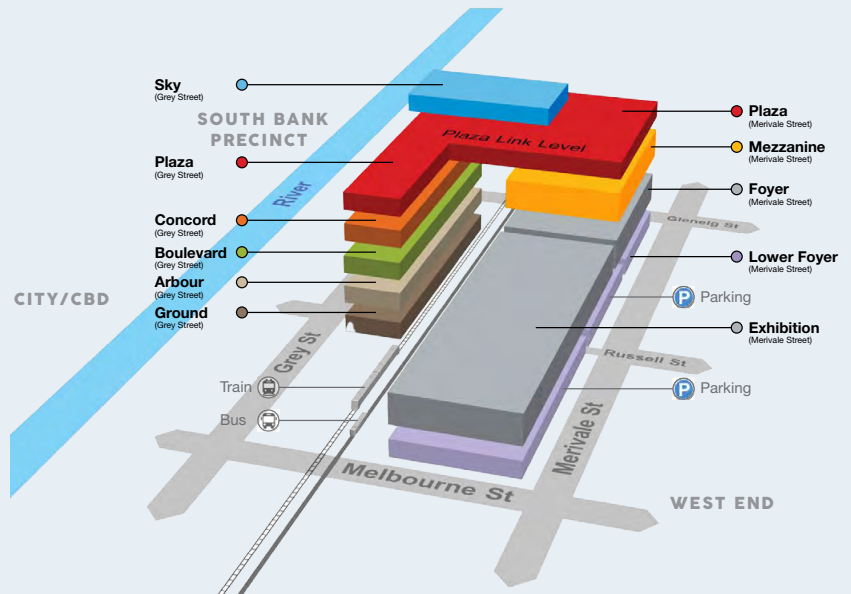
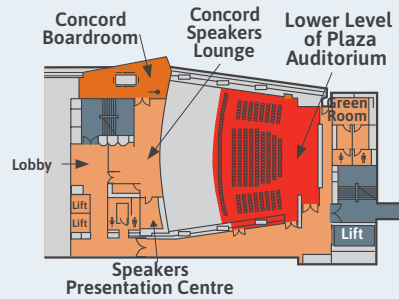

Sponsorship Opportunities

	PLATINUM \$30,000 (+GST)	GOLD \$22,500 (+GST)	SILVER \$12,500 (+GST)	BRONZE \$7,500 (+GST)
 Registrations	8	6	4	2
 Acknowledgement	Acknowledgement of Platinum sponsorship on website & inclusion of logo on BCC 2026 onsite Programme and all other promotional materials	Acknowledgement of Gold sponsorship on website & inclusion of logo on BCC 2026 onsite Programme and all other promotional materials	Acknowledgement of Silver sponsorship on website & inclusion of logo on BCC 2026 onsite Programme and all other promotional materials	Acknowledgement of Bronze sponsorship on website & inclusion of logo on BCC 2026 on-site Programme and all other promotional materials
 Exhibition Space	<p>Platinum sponsors will be in the conference concourse in the most pre-eminent positions.</p> <p>Open area to build 6m wide x 3m depth</p> <p>Additional Furniture/ Electrical can be ordered through Exponet. There will be an additional charge per item.</p>	<p>Exhibition booth 5m width x 3m depth</p> <p>Additional Furniture/ Electrical can be ordered through Exponet. There will be an additional charge per item.</p>	<p>Exhibition booth 4m width x 3m depth</p> <p>Additional Furniture/ Electrical can be ordered through Exponet. There will be an additional charge per item.</p>	<p>Exhibition booth 3m width x 3m depth</p> <p>Additional Furniture/ Electrical can be ordered through Exponet. There will be an additional charge per item.</p>
 Sponsored Satellite Meeting	<p>45-minute break in between each satellite symposium. Timings available are <u>generally</u> 12.20 & 13.15.</p> <p>The wording "Educational symposium supported by..." will be included in the BCC 2026 programme.</p> <p>In addition Platinum sponsors will be acknowledged as providing the Thursday lunch without additional cost to the sponsor.</p>	<p>Gold sponsors wishing to have a satellite symposium would be expected to contribute to the costs of catering for the main lunch on Thursday.</p> <p>The wording "Educational symposium supported by..." will be included in the BCC 2026 programme.</p>	x	x

PLATINUM

AUD \$30,000
(+GST)



Registrations

8 included Thursday and Friday

(does not include Thursday conference dinner)



Acknowledgement

Acknowledgement of Platinum sponsorship on website and inclusion of logo on the cover and on the sponsor page of the BCC 2026 on-site programme book.

Logo for sponsorship acknowledgement must be sent to BCC by 31st October 2025.



Exhibition Space

Open area to build is 6m width x 3m depth.

Spotlights, power socket(s), extension cable, counters and stools can be provided on request. Please contact Exponet for additional furniture/electrical at extra charge to sponsors.

Platinum sponsors will be in the conference concourse in the most pre-eminent positions that will be discussed with each client prior to the meeting. The carpet in the exhibition area and concourse will be utilised and additional carpeting will not be provided.

Exhibition Days:

Thursday 26th November – 7.00am registration open.

Programme start 8.00am and closes at 18.00.

Friday 27th November – 7.00am registration open.

Programme start 8.00am and exhibition open until 16.00pm.

Other conferences may require that exhibition stands are supervised at all times during opening times – BCC leaves this to the discretion of the individual exhibitors/sponsors. Security of laptops and other equipment on the exhibition stand is the responsibility of the individual exhibitor/sponsor.

Exhibition set-up/build:

Co-ordinated by **Exponet** and the BCC secretariat. *Time to be confirmed.*

Exhibition take-down:

Co-ordinated by **Exponet** and the BCC secretariat.

Friday – Latest 18:00 (following close of conference at 17:00). You will be required to complete an exhibition collection form with Brisbane Convention and Exhibition Centre (courier contact details etc.).

Extras and Filming at Exhibition Stand:

Extras such as coffee barista, food and drink provided at your stand or at the meeting must be notified as permission from the venue and completion of risk assessment/health and safety forms may be required. You must notify such extras to the BCC Secretariat before 31st October 2025. Filming is not allowed in the public conference areas – you may film at your exhibition stand but you must get the express permission from anyone being filmed and this is the responsibility of the sponsor.

PLATINUM

(CONTINUED)

AUD \$30,000
(+GST)



Sponsored Satellite Meeting

45 minutes

Timings of the symposia are coordinated with the conference organisers, based upon the number of companies presenting or supporting presentations at the meeting. Satellite meeting sponsors must consider that there is only a short break in between each sponsored satellite meeting for change of furniture on stage, filming or use of voting pads. Sponsors must notify the BCC Secretariat before 31st October 2025 if change of furniture or use of voting pads required or any other special instructions. Filming of satellite meetings is permitted – confirmation of this must be notified to the BCC as above including contact details to allow for equipment set-up. The provision of film equipment/crew is at the cost of the sponsor. Sponsors must state at the opening of their meeting that they are filming the session and the purpose of the filming so that the audience is fully informed. Platinum sponsors will be acknowledged as providing the Thursday lunch without additional cost to the sponsor.

Advertising the meeting:

Each satellite meeting will have an agenda in the digital programme – this must be provided to BCC by 31st October 2025. Platinum sponsors can place 1 standard pull-up stand advertising the symposium in the conference area (provided by sponsor) – this can be put up on Thursday from 11.00 and please remove after the satellite meeting has occurred.

Meeting Set-up:

All AV/conference equipment including data projector, laptop, comfort screen, chair and lectern microphones, pointers, additional microphones, staging, screens and full technical support are available. Microphones for Q&A are set up in the aisles on stands – BCC does not provide staff to pass roving microphones to audience at Q&A.

Satellite Meeting Programme:

All satellite meeting programmes must be approved by the BCC Organizing Committee and therefore the full programme and details of chair/speakers must be submitted by 31st October 2025. BCC rules dictate that a speaker/chair cannot participate in more than one satellite symposium at BCC 2026. Sponsors are asked to inform chair/speakers of this rule on the invitations to participate. Each sponsor is responsible for the registration of its own satellite meeting chair/speakers to BCC 2026 which remains free of charge apart from the conference gala dinner on Thursday evening.

Link to an Educational Website or Portal:

This should be for health care professionals for inclusion on the BCC website - the link will be subject to BCC steering committee approval.

Sponsored Satellite Meeting – Attendees, Scanners and Attendee Report:

BCC does not guarantee the number of attendees at sponsored satellite meetings. However, BCC will assist where it can to highlight/publicise satellite meeting times etc., e.g. by including details on BCC e-circulations (no cost).

Timings for satellite meetings and Platinum exhibition space positions will be allocated on a first-come reserved basis. Please send confirmation of Platinum sponsorship to dianematthewsobyrne@gmail.com and k.obyrne@qut.edu.au

GOLD

AUD \$22,500
(+GST)



Registrations

6 included Thursday and Friday

(does not include Thursday conference dinner)



Acknowledgement

Acknowledgement of Gold sponsorship on the BCC website and inclusion of logo on the sponsor page in the BCC 2026 on-site programme book.

Logo for sponsorship acknowledgement must be sent to BCC by 31st October 2025.



Exhibition Space

Exhibition booth 5m width x 3m depth – please do not exceed these dimensions.

Spotlights, power socket(s), extension cable, counters and stools can be provided on request. Please contact Exponet for additional furniture/electrical at extra charge to sponsors.

Gold sponsors will be in the conference concourse amongst the most preeminent positions that will be discussed with each client prior to the meeting. The carpet in the exhibition area and concourse will be utilised and additional carpeting will not be provided.

Exhibition Days:

Thursday 26th November – 7.00am registration open.

Programme start 8.00am and closes at 18.00.

Friday 27th November – 7.00am registration open.

Programme start 8.00am and exhibition open until 16.00pm.

Other conferences may require that exhibition stands are supervised at all times during opening times – BCC leaves this to the discretion of the individual exhibitors/sponsors. Security of laptops and other equipment on the exhibition stand is the responsibility of the individual exhibitor/sponsor.

Exhibition set-up/build:

Co-ordinated by **Exponet** and the BCC secretariat. *Time to be confirmed.*

Exhibition take-down:

Co-ordinated by **Exponet** and the BCC secretariat.

Friday – Latest 18:00 (following close of conference at 17:00). You will be required to complete an exhibition collection form with Brisbane Convention and Exhibition Centre (courier contact details etc.).

Extras and Filming at Exhibition Stand:

Extras such as coffee barista, food and drink provided at your stand or at the meeting must be notified as permission from the venue and completion of risk assessment/health and safety forms may be required. You must notify such extras to the BCC Secretariat before 31st October 2025. Filming is not allowed in the public conference areas – you may film at your exhibition stand but you must get the express permission from anyone being filmed and this is the responsibility of the sponsor.

Gold exhibition space positions will be allocated on a first-come reserved basis.

Please send confirmation of Gold sponsorship to dianemattthewsobyrne@gmail.com and k.obyrne@qut.edu.au

SILVER

AUD \$12,500 (+GST)



Registrations

4 included Thursday and Friday

(does not include Thursday conference dinner)



Acknowledgement

Inclusion of logo on the sponsor page in the BCC 2026 on-site programme book and acknowledgement of Silver sponsorship on the BCC website.

Logo for sponsorship acknowledgement and sponsor profile must be sent to BCC by 31st October 2025.



Exhibition Space

Exhibition booth 4m width x 3m depth – please do not exceed these dimensions.

Spotlights, power socket(s), extension cable, counters and stools can be provided on request. Please contact Exponet for additional furniture/electrical at extra charge to sponsors.

Silver sponsors will be in the conference concourse in positions that will be discussed with each client prior to the meeting. The carpet in the exhibition area and concourse will be utilised and additional carpeting will not be provided.

Exhibition Days:

Thursday 26th November – 7.00am registration open.

Programme start 8.00am and closes at 18.00.

Friday 27th November – 7.00am registration open.

Programme start 8.00am and exhibition open until 16.00pm.

Other conferences may require that exhibition stands are supervised at all times during opening times – BCC leaves this to the discretion of the individual exhibitors/sponsors. Security of laptops and other equipment on the exhibition stand is the responsibility of the individual exhibitor/sponsor.

Exhibition set-up/build:

Co-ordinated by **Exponet** and the BCC secretariat. *Time to be confirmed.*

Exhibition take-down:

Co-ordinated by **Exponet** and the BCC secretariat.

Friday – Latest 18:00 (following close of conference at 17:00). You will be required to complete an exhibition collection form with Brisbane Convention and Exhibition Centre (courier contact details etc.).

Extras and Filming at Exhibition Stand:

Extras such as coffee barista, food and drink provided at your stand or at the meeting must be notified as permission from the venue and completion of risk assessment/health and safety forms may be required. You must notify such extras to the BCC Secretariat before 31st October 2025. Filming is not allowed in the public conference areas – you may film at your exhibition stand but you must get the express permission from anyone being filmed and this is the responsibility of the sponsor.

Silver exhibition space positions will be allocated on a first-come reserved basis. Please send confirmation of Silver sponsorship to dianemattthewsobyrne@gmail.com and k.obyrne@qut.edu.au

BRONZE

AUD \$7,500
(+GST)



Registrations

2 included Thursday and Friday

(does not include Thursday conference dinner)



Acknowledgement

Acknowledgement of Bronze sponsorship on the BCC website and inclusion of logo on the sponsor page in the BCC 2026 on-site programme book.

Logo for sponsorship acknowledgement must be sent to BCC by 31st October 2025.



Exhibition Space

Exhibition booth 3m width x 3m depth – please do not exceed these dimensions.

Spotlights, power socket(s), extension cable, counters and stools can be provided on request. Please contact Exponet for additional furniture/Electrical at extra cost to the sponsor. The carpet in the exhibition area and concourse will be utilised and additional carpeting will not be provided.

Exhibition Days:

Thursday 26th November – 7.00am registration open.

Programme start 8.00am and closes at 18.00.

Friday 27th November – 7.00am registration open.

Programme start 8.00am and exhibition open until 16.00pm.

Other conferences may require that exhibition stands are supervised at all times during opening times – BCC leaves this to the discretion of the individual exhibitors/sponsors. Security of laptops and other equipment on the exhibition stand is the responsibility of the individual exhibitor/sponsor.

Exhibition set-up/build:

Co-ordinated by **Exponet** and the BCC secretariat. *Time to be confirmed.*

Exhibition take-down:

Co-ordinated by **Exponet** and the BCC secretariat.

Friday – Latest 18:00 (following close of conference at 17:00). You will be required to complete an exhibition collection form with Brisbane Convention and Exhibition Centre (courier contact details etc.).

Extras and Filming at Exhibition Stand:

Extras such as coffee barista, food and drink provided at your stand or at the meeting must be notified as permission from the venue and completion of risk assessment/health and safety forms may be required. You must notify such extras to the BCC Secretariat before 31st October 2025. Filming is not allowed in the public conference areas – you may film at your exhibition stand but you must get the express permission from anyone being filmed and this is the responsibility of the sponsor.

Bronze exhibition space positions will be allocated on a first-come reserved basis.

Please send confirmation of Bronze sponsorship to dianemattthewsobyne@gmail.com and k.obyrne@qut.edu.au

Additional Sponsorship Opportunities

Additional sponsorship opportunities open to sponsors of the BCC 2026 include the following:

Coffee cart sponsorship for both days of the conference	\$2,500 per day
Morning and afternoon refreshments on Thursday and Friday	\$2,000 per day
Sponsorship of the early morning symposia on Thursday	\$2,000 per symposium
Sponsorship of pre Gala dinner Canapes on Thursday	\$3,500
Sponsorship of a Gala Dinner table for 10 people	\$1,500

Summary

The Brisbane Cancer Conference, Queensland now plays a central role in research and education.

Reinforcing and establishing new relationships between researchers in Brisbane and Queensland and is unanimously now felt to be an important annual event in the Queensland conference calendar.

Last year BCC attracted a bumper attendance of delegates from a wide range of health professionals reflecting the previously unmet need for education and integration of research efforts for cancer researchers in Brisbane and Queensland.

Approximately 1,000 faculty and delegates; including medical, radiation and surgical oncologists, pathologists, palliative care physicians, nurses, pharmacists, allied healthcare, and industry professionals enjoyed the educational and networking benefits of the conference.

The meeting presented 'state-of-the-art' cancer treatment and research lectures from local experts and conducted research workshops. The conference also showcased our internationally recognised research from globally recognised key opinion leaders carrying out their work in Brisbane. This year we are hosting Breast, Lung, Prostate, Survivorship, and Immune-oncology symposia prior to the formal commencement of the Brisbane cancer conference itself.

With continued support, sponsorship, and collaboration from our partners in industry, education, and research, I am certain this event will go from strength to strength.

Comments from Previous BCC Attendees

“

Superb mix of speakers and topics.

”

“

Excellent, well organised conference. Excellent discussion on topical areas surrounding cancer research. Sessions ran to time and discussion encouraged.

”

“

The conference enhanced my research knowledge and made me aware of facilities in Brisbane I didn't know existed.

”

“

Wonderful conference. I thoroughly enjoyed all the sessions, with a fantastic mix of topics ranging from basic science to surgery. The question-and-answer part of the talks were also very informative and useful.

”

“

This is the largest local cancer conference ever held in Queensland. Long may it continue.

”

“

Fantastic multi-disciplinary meeting, great for networking.

”

“

The pre-conference symposia were excellent – real added value to the meeting!

”

“

Integration of electronic patient record and artificial intelligence a great finishing session

”

“

I really enjoyed the buzz and discussions in between the sessions over coffee and lunch.

”

“

Great opportunity to re connect with other researchers.

”

“

The conference dinner is now permanently in my social diary, such a great, fun night.

”

“

The conference was excellent but might benefit from being held earlier in the year.

”

BRISBANE CANCER CONFERENCE

26 – 27 November 2026
Brisbane Convention
and Exhibition Centre

Sponsorship Application Form

All prices are listed in AUD and exclude GST (10%).

Company

Postal Address

Contact Person

Telephone

E-mail address

Website

Sponsorship and Exhibition Packages (please tick preference)

Platinum	\$30,000
Gold	\$22,500
Silver	\$12,500
Bronze	\$7,500

Additional sponsorship opportunities for sponsors of the BCC 2026

Coffee cart sponsorship for both days of the conference	\$2,500 per day
Morning and afternoon refreshments on Thursday and Friday	\$2,000 per day
Sponsorship of the early morning symposia on Thursday	\$2,000 per symposium
Sponsorship of pre Gala dinner Canapes on Thursday	\$3,500
Sponsorship of a Gala Dinner table for 10 people	\$1,500

SUB TOTAL \$

PLUS 10% GST \$

TOTAL \$

Participation Terms & Conditions

1. Full payment is required on receipt of tax invoice to secure your Sponsorship and Exhibition requirements, including your Booth Allocation. Full payment of all invoices, including your representative/s registration and related fees, must be received prior to commencement of the Event to ensure admittance to the Event, unless by prior approval
2. All prices quoted exclude GST.
3. The Organising Committee reserves the right to refuse an application
4. The Organiser will endeavour to meet selected participation requirements and will contact you as soon as possible to discuss alternatives if your selected requirement/s are not available
5. Sponsorship/Booth cancellations must be in writing. A refund will only be provided if the sponsorship/booth is re-sold. A cancellation fee of 20% will apply to all cancellations. No cancellation/refund will be provided within 30 days of the conference start date
6. Sponsors and Exhibitors agree to abide by such conditions as laid down by the Organising Committee and agree not to violate any of the lease conditions of the conference venue
7. If the Sponsor/Exhibitor fails to comply with any of the rules and regulations laid down, or any requirements stipulated, the Organiser has the right to reassign the space and the Sponsor/Exhibitor will forfeit all monies paid
8. Acknowledgement of Sponsors in the Program / E-Brochure is dependent upon the date of the Sponsors booking, provision of the Sponsors logo and printing date of the books
9. All signage, collateral, advertisements and any other artwork must be provided to the Organiser for approval. The Organiser reserves the right to reject anything that it considers inappropriate
10. The Organiser reserves the right to redesign the floor plan and to relocate exhibition booth if required through changes to exhibition times, venue alterations or other factors
11. Exhibitors must have third party liability insurance cover. A Certificate of Currency is to be provided on request
12. Exhibitors must not erect any sign, display or obstruction which intrudes into any adjoining Exhibitors' space or affects the safety of the venue.
13. Exhibitors must not damage in any way the walls, floors, ceilings or any other part of the exhibition area or conference venue or the Exhibitor will be liable for all associated charges due to the venue
14. The Organiser accepts no responsibility whatsoever for any actions, suits, proceedings, claims, demands, costs and expenses, which may arise from the supply of samples or other material by participating Sponsors/Exhibitors to any person
15. The Organiser will take all precautions it considers necessary for the protection and security of exhibited articles but will not be responsible for the safety, loss, damage or compensation of any exhibit or other property under any circumstances whatsoever
16. Participants must not on-sell Sponsorship opportunities, sub-let exhibition booths, or display products or programs that have not been officially endorsed by their company without the prior approval of the Organiser
17. The Conference Organiser may shorten or lengthen the duration of the exhibition and alter the hours during which the exhibition is open
18. Unforeseen Circumstances / Force Majeure – If any act of terrorism, civil disturbance, industrial action, pandemic, natural disaster or event beyond the Organiser's control prevents us from carrying out our obligations we will not be liable for non-performance or refund, however, the Conference Organisers will work with all sponsors/exhibitors to achieve a fair and adequate outcome

In signing below, I confirm I understand and agree with the Participation Terms and Conditions. Furthermore, I confirm I am authorised to sign on behalf of the applicant.

Signed

Date

Name

Position

Please email completed form to dianematthewsobyrne@gmail.com and k.obyrne@qut.edu.au