



Brisbane Cancer Conference 2022 Prospectus & Invitation to Sponsor

Thursday, 24th November –

Friday 25th November 2022

Brisbane Convention and Exhibition Centre

Dear Colleagues,

With the establishment of the Health Translation Queensland, a partnership organisation that brings together 11 of Queensland's major medical research institutes and health care providers, including Queensland Health, Children's Health Queensland, Metro North Health, Metro South Health, West Moreton Health, Mater Group, The University of Queensland, Queensland University of Technology, QIMR Berghofer Medical Research Institute, Translational Research Institute, and CSIRO's Australian e-Health Research Centre, this meeting is an opportunity to draw together cancer researchers in Brisbane and Queensland to advance collaborative efforts in cancer research.

The meeting comprises plenary lectures and workshops on recent scientific, technological, nursing, and medical advances in the diagnosis and treatment of malignant disease.

On Thursday 24th November, the meeting will start with Breast Cancer, Prostate Cancer, and Immunotherapy meetings, amongst others, running from 8am - 12pm in the morning. There will be satellite symposia at lunchtime followed by plenary lectures from 2 – 4pm and subsequently workshops in these areas running from 4:30 – 6:30pm.

A symposium dinner will be held on Thursday evening offering the opportunity to socialise with colleagues particularly from other institutions in the city and from Queensland.

The all-day session on Friday 25th November will include plenary lectures followed by tumour-site specific workshops in the morning and afternoon. A key session will be lectures by Queensland oncology researchers that have contributed to global advances in our understanding of the epidemiology, molecular biology, and treatment of malignant disease.

Nearly 1,000 delegates attended each day at the event last year demonstrating the value of a truly multi-disciplinary annual Queensland Translational Cancer Conference in Brisbane.

This conference is made possible through the support of the PA Research Foundation, Cancer Council Queensland, Health Translation Queensland, our sponsors, the time, and effort of the chairs who put the workshops together as well as Therese and the QUT Cancer and Ageing Research Program (CARP) team.

Best wishes for what should be an enjoyable and fulfilling two days.
Yours sincerely,

A handwritten signature in black ink, appearing to be 'K. O'Byrne', with a long horizontal stroke extending to the right.

Professor Kenneth O'Byrne, Consultant Medical Oncologist & Clinical Scientist

YOUR HOST FOR BCC 2022



Professor Kenneth O'Byrne is a Medical Oncologist and Clinical Scientist working at the Princess Alexandra Hospital (PAH) and Queensland University of Technology (QUT) Translational Research Institute (TRI) laboratories on the PAH campus. He is president of the British Thoracic Oncology Group (BTOG), a board member of the European thoracic oncology platform (ETOP), a member of the ESMO chest tumours faculty and is involved in the International Association for the Study of Lung Cancer (IASLC) and Thoracic Alliance for Cancer Trials (TACT). In Australia, he is a member of Australian Lung cancer Trials Group (ALTG), Medical Oncology Group of Australasia (MOGA) and Australian Genomics Health Alliance (AGHA).

Professor O'Byrne has been involved in over 150 Clinical Trials in his career including designing investigator-initiated, grant-funded Phase II and III studies. He has established collaborative studies and networks for biomarker detection and validation and has been involved in biomarker driven clinical trials including the LUX-Lung (Boehringer-Ingelheim), checkpoint immunotherapy (BMS, MSD) and the ETOP programs. He is clinical lead for the 'Cancer and Ageing Research Program' at PAH-QUT-TRI, his research includes biomarker identification in solid and liquid biopsies, and drug resistance linked to cancer 'stemness' and genomic instability.

He has published over 350 peer-reviewed manuscripts and has recently patented novel anti-cancer therapeutics and predictive biomarker tests in Australia and Ireland. He and his collaborators have successfully applied for NHMRC, CCA, CCQ, Prostate Cancer Foundation of Australia (PCFA) and "Movember" grants in Australia.

CONFERENCE VENUE



The 2022 Brisbane Cancer Conference will be held at the Brisbane Convention and Entertainment Centre (BCEC), located in the iconic South Bank precinct. The Centre is Earth Check Gold accredited and has been awarded AIPC Quality Standards Gold Certification for accomplishments in international convention centre performance standards. BCEC was the successful host venue for the G20 Leaders' Summit in 2014, voted #1 convention centre in the world in 2016-2018 and runner up in 2021.

With the excellent Team from BCEC and support and sponsorship from our partners in Research, Education, and Industry we look forward to building on our success over the previous Brisbane Cancer Conferences.

VENUE FLOOR PLANS



BRISBANE CONVENTION & EXHIBITION CENTRE

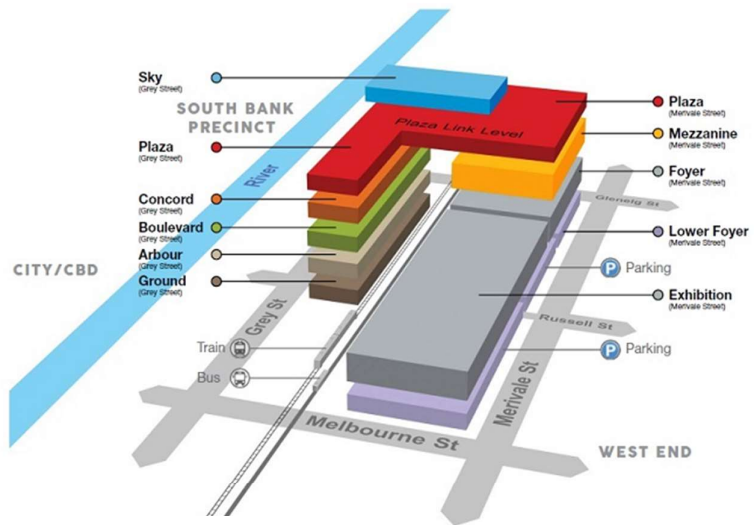

Boulevard Level

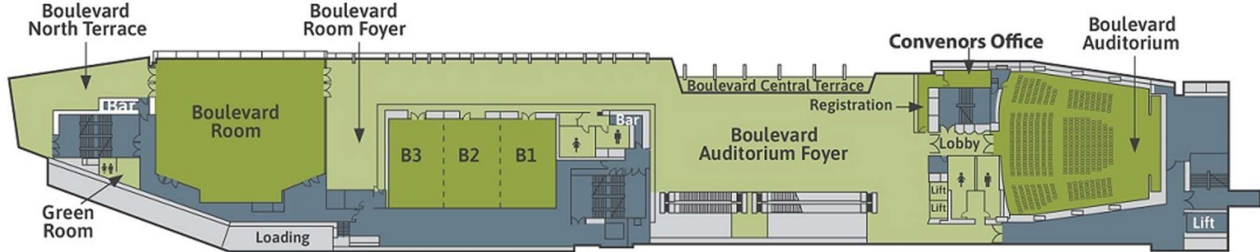

Arbour Level

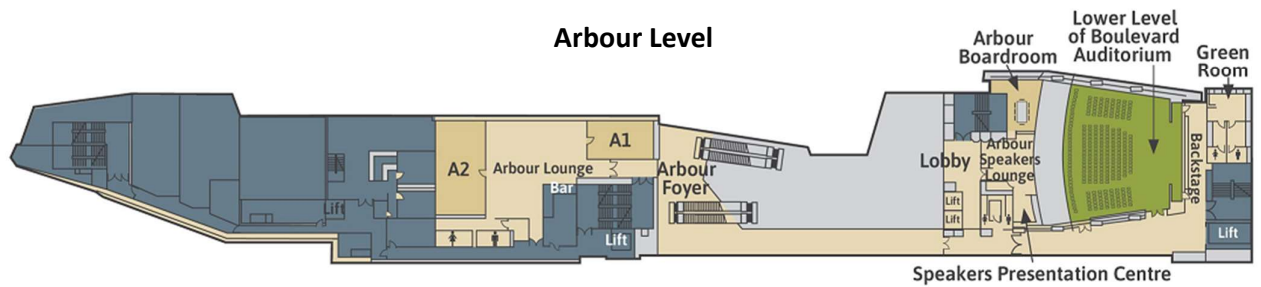

SPONSORSHIP OPPORTUNITIES

	PLATINUM \$30,000 (+GST)	GOLD \$22,500 (+GST)	SILVER \$12,500 (+GST)	BRONZE \$7,500 (+GST)
REGISTRATIONS	8	6	4	2
ACKNOWLEDGE- MENT	Acknowledgement of Platinum sponsorship on website & inclusion of logo on BCC 2022 on-site Programme and all other promotional materials	Acknowledgement of Gold sponsorship on website & inclusion of logo on BCC 2022 on-site Programme and all other promotional materials	Acknowledgement of Silver sponsorship on website & inclusion of logo on BCC 2022 on-site Programme and all other promotional materials	Acknowledgement of Bronze sponsorship on website & inclusion of logo on BCC 2022 on-site Programme and all other promotional materials
EXHIBITION SPACE	Platinum sponsors will be in the conference concourse in the most pre-eminent positions. Open area to build 6m wide x 3m depth Additional Furniture/Electrical can be ordered through Exponet. There will be an additional charge per item	Exhibition booth 5m width x 3m depth Additional Furniture/Electrical can be ordered through Exponet. There will be an additional charge per item	Exhibition booth 4m width x 3m depth Additional Furniture/Electrical can be ordered through Exponet. There will be an additional charge per item	Exhibition booth 3m width x 3m depth Additional Furniture/Electrical can be ordered through Exponet. There will be an additional charge per item
SPONSORED SATELLITE MEETING	45-minute break in between each satellite symposium. Timings available are 12.20 & 13.15. The wording "Educational symposium supported by..." will be included in the BCC 2022 programme	X	X	X

EXHIBITION AND SPONSORSHIP PACKAGES

PLATINUM \$30,000 AUD (+GST)

Registrations: 8 included Thursday and Friday (does not include Thursday conference dinner).

Acknowledgement: Acknowledgement of Platinum sponsorship on website and inclusion of logo on the cover and on the sponsor page of the BCC 2022 on-site programme book. Sponsor profile (max 100 words) in the programme book. Logo for sponsorship acknowledgement and sponsor profile must be sent to BCC by 1st November 2022.

Exhibition Space: Open area to build is 6m width x 3m depth. Spotlights, power socket(s), extension cable, counters and stools can be provided on request. Please contact Exponet for additional furniture/electrical at extra charge to sponsors. Platinum sponsors will be in the conference concourse in the most pre-eminent positions that will be discussed with each client prior to the meeting. The carpet in the exhibition area and concourse will be utilised and additional carpeting will not be provided.

Exhibition Days: Thursday and Friday. Thursday 24th November – 12.00pm registration open/programme start – 14:00 and close at 18.00. Friday 25th November – 8am registration open/programme start, and exhibition open until 16.00pm. Other conferences may require that exhibition stands are supervised at all times during opening times – BCC leaves this to the discretion of the individual exhibitors/sponsors. Security of laptops and other equipment on the exhibition stand is the responsibility of the individual exhibitor/sponsor.

Exhibition set-up/build: Co-ordinated by **Exponet** and the BCC Secretariat. Thursday 04:30 - 07:30

Exhibition take-down: Co-ordinated by **Exponet** and the BCC Secretariat. Friday – Latest 18:00 (following close of conference at 17.00). You will be required to complete an exhibition collection form with Brisbane Convention and Exhibition Centre (courier contact details etc.).

Extras and Filming at Exhibition Stand: Extras such as coffee barista, food and drink provided at your stand or at the meeting must be notified as permission from the venue and completion of risk assessment/health and safety forms may be required. You must notify such extras to the BCC Secretariat before 1st November 2022. Filming is not allowed in the public conference areas – you may film at your exhibition stand but you must get the express permission from anyone being filmed and this is the responsibility of the sponsor.

Platinum Sponsorship (continued)

Sponsored Satellite Meeting: 45 minutes + 15 minutes break in between each satellite symposium. Timings available are 12.00 and 13.00. Further timings may be available subject to discussion with BCC Secretariat. Satellite meeting sponsors must consider that there is only a 15-minute break in between each sponsored satellite meeting for change of furniture on stage, filming, or use of voting pads. Sponsors must notify the BCC Secretariat before 1st November 2022 if change of furniture or use of voting pads required or any other special instructions. Filming is allowed of satellite meetings – confirmation of this must be notified to the BCC as above including contact details to allow for equipment set-up. The provision of film equipment/crew is at the cost of the sponsor. Sponsors must state at the opening of their meeting that they are filming the session and the purpose of the filming so that the audience is fully informed.

Advertising the meeting: The wording “*Satellite symposium sponsored by ... - see page ... for satellite details*” only will be included in the BCC 2022 programme. Each satellite meeting will have 1 x A4 Agenda printed in the programme book – this must be provided to BCC in PDF format by 1st November 2022. Platinum sponsors can place 1 standard pull-up stand advertising the symposium in the conference area (provided by sponsor) – this can be put up on Thursday from 11.00 and please remove after the satellite meeting has occurred.

Meeting Set-up: All AV/conference equipment including data projector, laptop, comfort screen, chair and lectern microphones, pointers, additional microphones, staging, screens and full technical support are available. Microphones for Q&A are set up in the aisles on stands – BCC does not provide staff to pass roving microphones to audience at Q&A.

Satellite Meeting Programme: All satellite meeting programmes must be approved by the BCC Organising Committee and therefore the full programme and details of chair/speakers must be submitted by 1st November 2022. BCC rules dictate that a speaker/chair cannot participate in more than one satellite symposium at BCC 2022. Sponsors are asked to inform chair/speakers of this rule on the invitations to participate. Each sponsor is responsible for the registration of its own satellite meeting chair/speakers to BCC 2022 which remains free of charge apart from the conference gala dinner on Thursday evening.

Link to an Educational Website or Portal: This should be for health care professionals for inclusion on the BCC website in the Information Links section - the link will be subject to BCC Organising Committee approval.

Sponsored Satellite Meeting – Attendees, Scanners and Attendee Report: BCC does not guarantee the number of attendees at sponsored satellite meetings. However, BCC will assist where it can to highlight/publicise satellite meeting times etc., e.g. by including details on BCC e-circulations (no cost).

Timings for satellite meetings and Platinum exhibition space positions will be allocated on a first-come reserved basis. Please send confirmation of Platinum sponsorship to dianemattthewsobyrne@gmail.com and k.obyrne@qut.edu.au

GOLD \$22,500 AUD (+GST)

Registrations: 6 included for Thursday and Friday (does not include Thursday conference dinner)

Acknowledgement: Acknowledgement of Gold sponsorship on the BCC website and inclusion of logo on the sponsor page in the BCC 2022 on-site programme book. Sponsor profile (max 100 words) in the programme book. Logo for sponsorship acknowledgement and sponsor profile must be sent to BCC by 1st November 2022.

Exhibition Space: Exhibition booth 5m width x 3m – please do not exceed these dimensions. Spotlights, power socket(s), extension cable, counters and stools can be provided on request. Please contact Exponet for additional furniture/electrical at extra charge to sponsors. Gold sponsors will be in the conference concourse amongst the most pre-eminent positions that will be discussed with each client prior to the meeting. The carpet in the exhibition area and concourse will be utilised and additional carpeting will not be provided.

Exhibition Days: Thursday 24th November – 12.00pm registration open/programme start – 14:00 and close at 18.00. Friday 25th November – 8am registration open/programme start, and exhibition open until 16.00pm. Other conferences may require that exhibition stands are supervised at all times during opening times – BCC leaves this to the discretion of the individual exhibitors/sponsors. Security of laptops and other equipment on the exhibition stand is the responsibility of the individual exhibitor/sponsor.

Exhibition set-up/build: Co-ordinated by Exponet and the BCC Secretariat. Thursday 04:30 - 07:30.

Exhibition take-down: Co-ordinated by Exponet and the BCC Secretariat. Friday – Latest 18:00 (following close of conference at 17.00). You will be required to complete an exhibition collection form with Brisbane Convention and Exhibition Centre (courier contact details etc.).

Extras and Filming at Exhibition Stand: Extras such as coffee barista, food and drink provided at your stand or at meeting must be notified as permission from the venue and completion of risk assessment/health and safety forms may be required. You must notify such extras to the BCC Secretariat before 1st November 2022. Filming is not allowed in the public conference areas – you may film at your exhibition stand but you must get the express permission from anyone being filmed and this is the responsibility of the sponsor.

Gold exhibition space positions will be allocated on a first-come reserved basis. Please send confirmation of Gold sponsorship to dianematthewsobyrne@gmail.com and k.obyrne@qut.edu.au

SILVER \$12,500 AUD (+GST)

Registrations: 4 included for Thursday and Friday (does not include Thursday conference dinner).

Acknowledgement: Inclusion of logo on the sponsor page in the BCC 2022 on-site programme book and acknowledgement of Silver sponsorship on the BCC website. Sponsor profile (max 100 words) in the programme book. Logo for sponsorship acknowledgement and sponsor profile must be sent to BCC by 1st November 2022.

Exhibition Space: Exhibition booth 4m width x 3m depth – please do not exceed these dimensions. Spotlights, power socket(s), extension cable, counters and stools can be provided on request. Please contact Exponet for additional furniture/electrical at extra charge to sponsors. Silver sponsors will be in the conference concourse in positions that will be discussed with each client prior to the meeting. The carpet in the exhibition area and concourse will be utilised and additional carpeting will not be provided.

Exhibition Days: Thursday 24th November – 12.00pm registration open/programme start – 14:00 and close at 18.00. Friday 25th November – 8am registration open/programme start, and exhibition open until 16.00pm. Other conferences may require that exhibition stands are supervised at all times during opening times – BCC leaves this to the discretion of the individual exhibitors/sponsors. Security of laptops and other equipment on the exhibition stand is the responsibility of the individual exhibitor/sponsor.

Exhibition set-up/build: Co-ordinated by Exponet and the BCC Secretariat. Thursday 04:30 - 07:30.

Exhibition take-down: Co-ordinated by Exponet and the BCC Secretariat. Friday – Latest 18:00 (following close of conference at 17.00). You will be required to complete an exhibition collection form with Brisbane Convention and Exhibition Centre (courier contact details etc.).

Extras and Filming at Exhibition Stand: Extras such as coffee barista, food and drink provided at your stand or at meeting must be notified as permission from the venue and completion of risk assessment/health and safety forms may be required. You must notify such extras to the BCC Secretariat before 1st November 2022. Filming is not allowed in the public conference areas – you may film at your exhibition stand but you must get the express permission from anyone being filmed and this is the responsibility of the sponsor.

Silver exhibition space positions will be allocated on a first-come reserved basis. Please send confirmation of Silver sponsorship dianemattthewso Byrne@gmail.com and k.obyrne@qut.edu.au

BRONZE \$7,500 AUD (+GST)

Registrations: 2 included for Thursday and Friday (does not include Thursday conference dinner)

Acknowledgement: Acknowledgement of Bronze sponsorship on the BCC website and inclusion of logo on the sponsor page in the BCC 2022 on-site programme book. Logo for sponsorship acknowledgement and sponsor profile must be sent to BCC by 1st November 2022.

Exhibition Space: Exhibition booth 3m width x 3m depth – please do not exceed these dimensions. Spotlights, power socket(s), extension cable, counters and stools can be provided on request. Please contact Exponet for additional furniture/electrical at extra cost to the sponsor. The carpet in the exhibition area and concourse will be utilised and additional carpeting will not be provided.

Exhibition Day: Thursday 24th November – 12.00pm registration open/programme start – 14:00 and close at 18.00. Friday 25th November – 8am registration open/programme start, and exhibition open until 16.00pm. Other conferences may require that exhibition stands are supervised at all times during opening times – BCC leaves this to the discretion of the individual exhibitors/sponsors. Security of laptops and other equipment on the exhibition stand is the responsibility of the individual exhibitor/sponsor.

Exhibition set-up/build: Co-ordinated by Exponet and the BCC Secretariat. Thursday 04:30 - 07:30.

Exhibition take-down: Co-ordinated by Exponet and the BCC Secretariat. Friday – Latest 18:00 (following close of conference at 17.00). You will be required to complete an exhibition collection form with Brisbane Convention and Exhibition Centre (courier contact details etc.).

Extras and Filming at Exhibition Stand: Extras such as coffee barista, food and drink provided at your stand or at meeting must be notified as permission from the venue and completion of risk assessment/health and safety forms may be required. You must notify such extras to the BCC Secretariat before 1st November 2022. Filming is not allowed in the public conference areas – you may film at your exhibition stand but you must get the express permission from anyone being filmed and this is the responsibility of the sponsor.

Bronze exhibition space positions will be allocated on a first-come reserved basis. Please send confirmation of Bronze sponsorship dianemattthewsobyrne@gmail.com and k.obyrne@qut.edu.au

OPPORTUNITIES

BCC PROGRAM

The Conference programme will include your company's logo and will be available to every attendee on-line and at the conference. The program will follow the same structure as last year and a copy of the 2022 event is enclosed.

AUDIENCE

Face-to-face interactions with local researchers, clinicians, and educators in the Oncology field.

ADVERTISING

The BCC 2022 will be advertised in the lead-up to the event via email and flyers and your company logo will be included.

CONNECT

BCC 2022 will give your company the opportunity to connect and be recognised for supporting and working collaboratively with local researchers, clinicians and educators in the Oncology field.

SUMMARY

The Brisbane Cancer Conference, Queensland now plays a central role in research and education. Reinforcing and establishing new relationships between researchers in Brisbane and Queensland and is unanimously felt to be an important new annual event in the Queensland conference calendar. With the COVID-19 emergency this conference will take on even more relevance in keeping attendees abreast of recent advances in cancer care and novel research technologies.

Last year BCC attracted a bumper attendance of delegates from a wide range of health professionals reflecting the previously unmet need for education and integration of research efforts for cancer researchers in Brisbane and Queensland. Approximately 1,000 faculty and delegates; including medical, radiation and surgical oncologists, pathologists, palliative care physicians, nurses, pharmacists, allied healthcare, and industry professionals enjoyed the educational and net-working benefits of the conference each day. The meeting presented 'state-of-the-art' cancer treatment and research lectures from local experts and conducted research workshops. The conference also showcased our internationally recognised research from globally recognised key opinion leaders carrying out their work in Brisbane. This year we are hosting Breast, Prostate, Survivorship, and Immune-oncology mini-symposia prior to the formal commencement of the Brisbane cancer conference itself.

With continued support, sponsorship, and collaboration from our partners in industry, education, and research, I am certain this event will go from strength to strength.

COMMENTS FROM PREVIOUS BCC ATTENDEES

- *Fantastic multi-disciplinary meeting, great for networking.*
- *Excellent, well organised conference. Excellent discussion on topical areas surrounding cancer research. Sessions ran to time and discussion encouraged.*
- *Wonderful conference. I thoroughly enjoyed all the sessions, with a fantastic mix of topics ranging from basic science to surgery. The question-and-answer part of the talks were also very informative and useful.*
- *Superb mix of speakers and topics.*
- *The conference enhanced my research knowledge and made me aware of facilities in Brisbane I didn't know existed.*
- *The conference was excellent but might benefit from being held earlier in the year.*
- *This is the largest local cancer conference ever held in Queensland. Long may it continue.*
- *The pre-conference symposia were excellent – real added value to the meeting!*
- *Integration of electronic patient record and artificial intelligence a great finishing session*
- *Great opportunity to re connect with other researchers*
- *I really enjoyed the buzz and discussions in between the sessions over coffee and lunch*
- *The conference dinner is now permanently in my social diary, such a great, fun night*